

No:	SB175-17		
Date:	11/09/2017	Issue:	1

Subject:	Elite 2 Steering Lever Inspection
-----------------	-----------------------------------

Dennis Eagle are asking all operators of Elite 2 to closely inspect their vehicles steering arms on the next vehicle inspection and all following inspections as part of your routine maintenance.

Fig.1



There are three types of steering lever:

Forged as shown in Fig. 1

Machined as shown in Fig. 2

Machined double drag link mount as shown in Fig. 3

Fig. 2

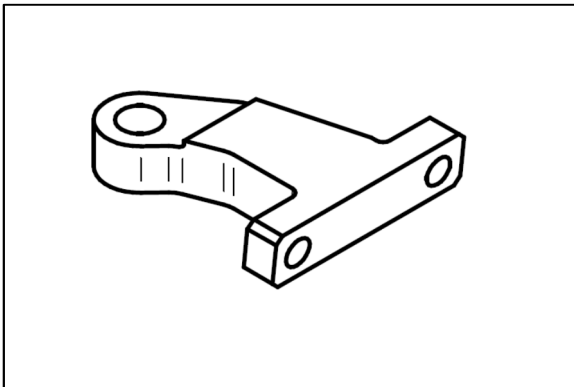
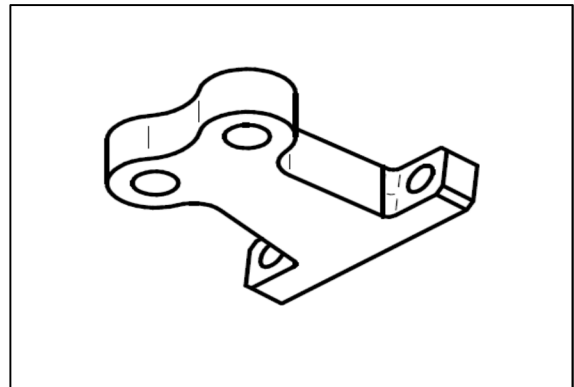

Fig. 3



No:	SB175-17		
Date:	11/09/2017	Issue:	1

Subject:	Elite 2 Steering Lever Inspection
-----------------	-----------------------------------

If any problems are found please contact Dennis Eagle Warranty at WarrantyAdmin@dennis-eagle.co.uk quoting the chassis number giving details of your findings, subject to the findings a new lever will be supplied on an FOC basis for you to fit.

If you find any problems with this lever it is recommended the vehicle should not be used until the lever is replaced.

- Torques values for the mounting bolts to the stub axle are 705 – 779 Nm, bolts should have Loctite 277 applied before screwing into the axle.
- Torque value for the drag link nut is 200-280Nm, a new split pin should be fitted.

For more detailed instructions on the fitment please use the appropriate Elite 2 Workshop Manual.